



53220 Thrust ball bearings, single direction

- Popular item

Thrust ball bearings, single direction

Bearing data

[Tolerances,](#)
table 1

Bearing interfaces

[Seat tolerances for standard](#)
[conditions,](#)
[Tolerances and resultant fit](#)

Technical specification

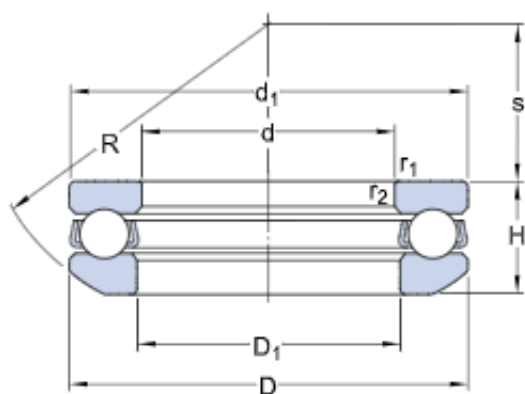

DIMENSIONS

d	100 mm	Bore diameter
D	150 mm	Outside diameter
H	40.9 mm	Height
H ₁	45 mm	Height bearing including seat washer
d ₁	≈ 150 mm	Outside diameter shaft washer
D ₁	≈ 103 mm	Inner diameter housing washer
D ₂	125 mm	Inner diameter sphered seat washer
D ₃	155 mm	Outside diameter sphered housing washer
C	14 mm	Height sphered housing washer
R	112 mm	Radius sphered housing washer
s	52 mm	Centre height housing washer sphere
r _{1,2}	min. 1.1 mm	Chamfer dimension washer

ABUTMENT DIMENSIONS

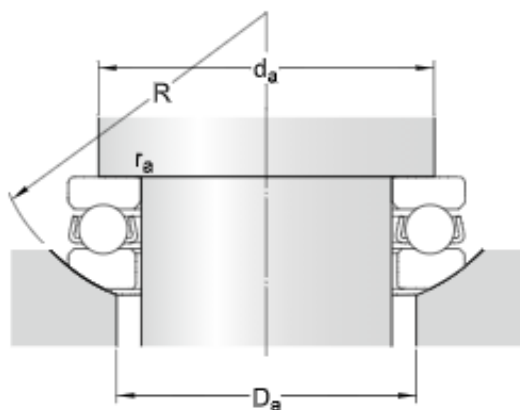

d_a min. 130 mm Abutment diameter shaft

D_a max. 125 mm Abutment diameter housing

r_a max. 1 mm Fillet radius



CALCULATION DATA

C	119 kN	Basic dynamic load rating
C_0	325 kN	Basic static load rating
P_u	10.8 kN	Fatigue load limit
	1 700 r/min	Reference speed
	2 400 r/min	Limiting speed
A	0.62	Minimum load factor

MASS

2.7 kg	Mass bearing (including seat washer where applicable)
--------	---

ASSOCIATED PRODUCTS